

SPINDLE CARTRIDGE REPLACEMENT

CAREFULLY READ CONVERSION INSTRUCTIONS TO ENSURE THE HANDLE SET OPERATES PROPERLY.

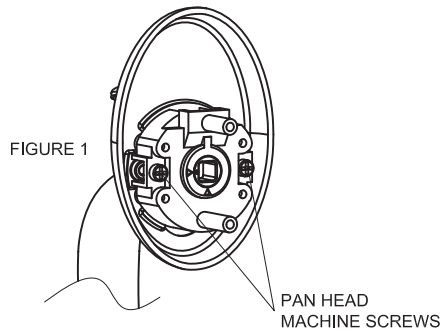

1. REMOVE 2 PAN HEAD MACHINE SCREWS FROM THE BACKSIDE OF THE THUMBTURN PULL ASSEMBLY TO REMOVE SPINDLE CARTRIDGE. REFER TO FIGURE 1.

2. INSERT THE TONGUE OF THE THUMB PIECE INTO THE SLOT ON THE UNDERSIDE OF THE SPINDLE CARTRIDGE

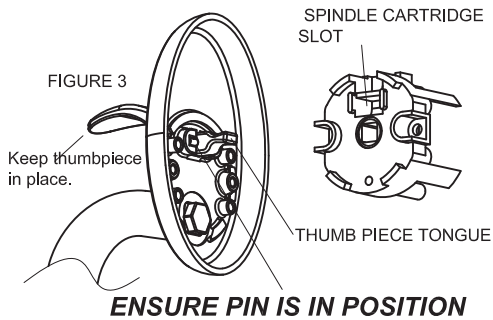

3. ENSURING THE THUMBPIECE IS RAISED AND PIN BEHIND IS IN POSITION - ALIGN SCREW HOLES AND SECURE THE THUMB PIECE TONGUE INTO THE SLOT ON THE SPINDLE CARTRIDGE. SECURE IN PLACE USING THE 2 PAN HEAD MACHINE SCREWS. REFER TO FIGURE 4.

**** Do not overtighten screws ****

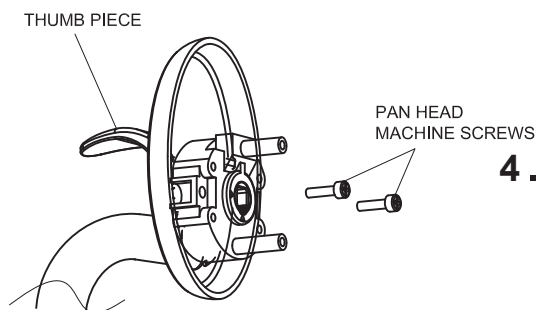

4. AFTER INSTALLATION DEPRESS THUMB LEVER TO ENSURE OPERATION IS SMOOTH AND SPINDLE HUB ROTATES.

ROCKWELL SECURITY INC.