

Swing Door Handle Set Installation Instructions



A Phillips screwdriver is required. Do NOT use power tools.

A Hex wrench for set screws is provided in the hardware package.

To prevent damage to the handle set while in construction phase, use a construction handle to operate the door. Lift to engage multipoint to close door. Push down to open the door. Construction handles are sold separately.

Use water to clean. Do not use brass cleaner as it will remove the protective coating.

Note: Handles and back plates vary by style but application is the same.

Exploded View of Parts

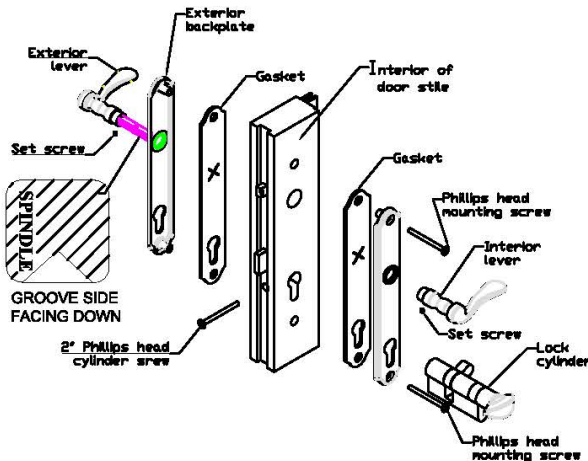

Swing Door Handle Operational Instructions

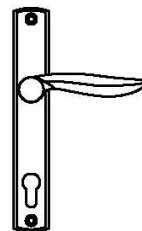

TO Lock
Push door closed
to engage the Latch

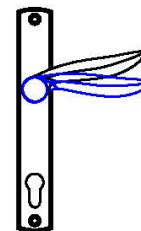

TO Lock
Lift Handle up to
engage the top and
bottom locking
points
prior to engaging
the deadbolt

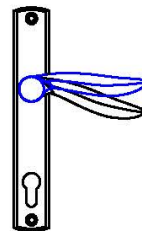

TO Unlock the door,
using a key or the
thumbturn, unlock the
deadbolt, then push down
on the lever to unlock the
top, bottom locking points
along with the latches, then
open the door.

1. Apply the backplate gasket to the inside of the exterior back plate. Push gasket firmly onto place to ensure a tight seal. Apply the back plate gasket to the inside of the interior back plate. Apply interior and exterior back plates and fasten loosely with the two screws provided. Note: The screw heads must be on the interior side of the door.
2. Insert the handle shaft into the handle. Be sure to orient the shaft as shown with the spindle groove facing down. Screw the set screw until flush with handle using the allen wrench. Insert the handle into the latch hole.
3. Install the interior handle on the shaft through the latch hole, pressing tightly to the back plates. Tighten the interior handle set screw with allen wrench. Screw until flush with handle.
4. Insert the keyed cylinder from the interior side of the door until it is the cam of the cylinder aligns with the center of the lock protruding slightly on the exterior back plate. Install the cylinder screw in the screw hole below the deadbolt in the edge of the door.
5. Tighten the back plate screws

Europrofile Cylinder

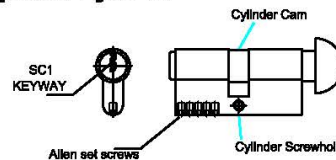

Europrofile cylinders come with the SC1 keyway.
Cylinders can be rekeyed to SC1 keys.

Troubleshooting Guide Multipoint Swing Door Hardware

Be certain door is square in frame before adjusting other hardware.
With the door in the open position, engage system by depressing, lifting handle and extend deadbolt by turning thumb turn.
If the system operates on the door edge and the deadbolt operates, the hardware system is fully functional.

1. SYSTEM WILL NOT OPERATE WHEN YOU LIFT THE HANDLE

Probable Cause: Improper installation of handle set.
Solution: Remove handle and reinstall. See Handle Set Installation Instructions.

2. SYSTEM OPERATES IN THE OPEN POSITION WHEN YOU LIFT THE HANDLE BUT NOT IN THE CLOSED POSITION WITH THE DOOR SHUT

Probable Cause: Relationship of door in the frame.
Solution: Check to make sure the door is square in the frame.

3. LOCKING POINTS WILL NOT ENGAGE WITH DOOR SHUT

Probable Cause: Deadbolt is not fully extending.
Solution: Clear away anything blocking travel of deadbolt (Insulation, wood, etc.).

4. DEADBOLT WILL NOT FULLY ENGAGE

Probable Cause: Locking points are not fully engaged. System design does not permit deadbolt operation unless locking points are fully engaged.
Solution: Check system again for binding problems. Confirm deadbolt extends fully into strike. Check to confirm locking points are correctly engaging strikes on the frame.

5. THUMBTURN OR KEY WILL NOT TURN

Probable Cause: Back plates may not be on straight.
Solution: Confirm that inside and outside holes line up with lock case. Loosen back plate screws 1/4 turn.