



Thanks for purchasing the Rockwell Sliding Door handle

All sliding doors are not alike. Some sliding doors are made of Wood, Vinyl, Aluminum or Fiberglass depending on the door manufacturer. Some doors have surface mounted locks and some have mortise locks, it varies depending on the door manufacturer or lock type used on the particular door.

There are also various sliding door mortise locks from different manufacturers. Rockwell Sliding Door handles are built to fit a large percentage of doors with a mortise lock application that have a screw-hole spacing 3-15/16" (3.94") apart. It will work with single and dual point mortise locks that have a screw-hole spacing of 3-15/16" (3.94"). Again not all locks are alike. If your existing door does not have screw-holes 3-15/16" (3.94") apart, then the Rockwell Sliding door handle may not work on your door application.

CROSS BORE PATTERN

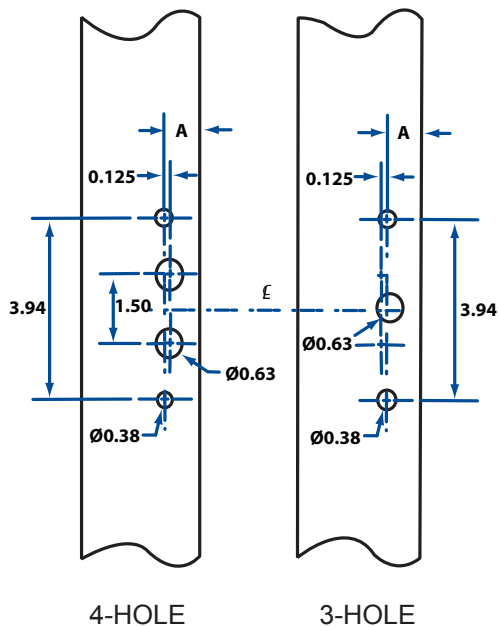

** Rockwell Non Keyed Sliding Door Handle will work for 3-hole and 4-hole machining on the face of the door with 3-15/16" (3.94") CTC screwholes. Please re-check door machining prior to ordering handle set.

**** Handle set do not include the mortise lock and keepers.**

Sliding doors also have varying degrees of door thicknesses depending on the door manufacturer.

We have included 2 sets of screws with your Sliding door handles to fit doors from 1-1/2" thick to 1-3/4".

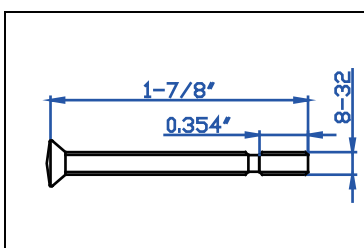

Screws to fit door thickness of 1.398"-1.555" [35.5-39mm]

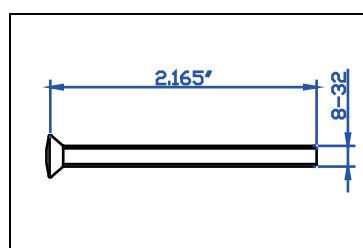

Screws to fit door thickness of 1.693"-1.850" [43-47 mm]



Thanks for purchasing the Rockwell Sliding Door handle

If you have purchased a Rockwell Sliding door handle with a keylock feature, please note, Rockwell Sliding door handles with keylock feature, are built with a center keylock to fit door with a 3 hole machining on the face and will only fit 1-3/4" thick doors.

If your door thickness is less than 1-3/4" the sliding door handle with keylock will not work as the cylinder tailpiece will clash with the internal thumbturn lever preventing the proper operation of the locks.

If your door has 4 hole on the face, it requires an offset keylock and the center keylock handle will not work on your door.

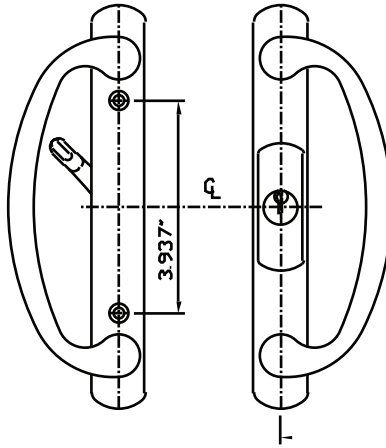

CENTER KEYLOCK

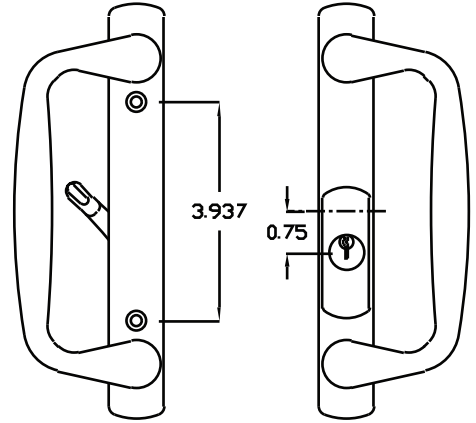

OFFSET KEYLOCK

Due to different types of sliding door handles, mortise locks and keepers which vary from the different door manufacturers, the handles, mortise locks and keepers are sold separately. Should you need additional information, please visit our storefront or website. Some examples of the different types of keepers and locks are below.

