

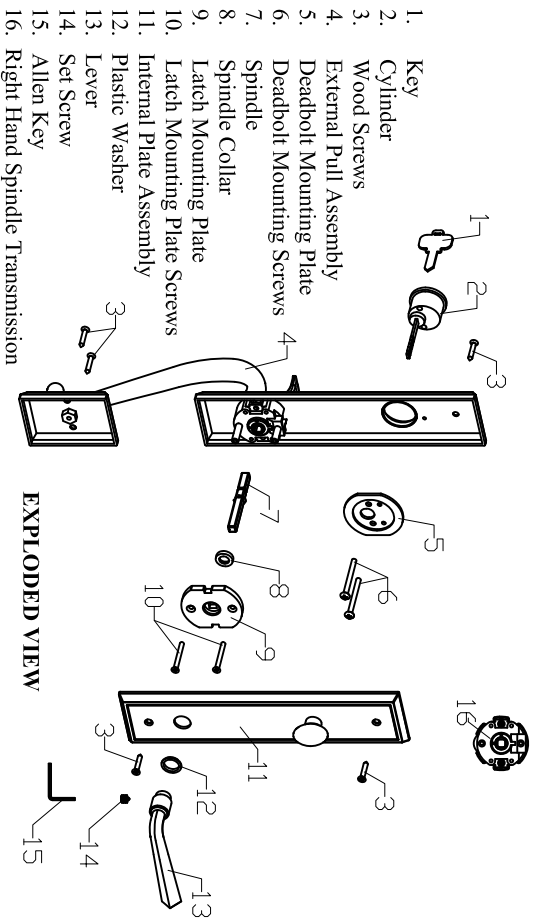

SAN JOSE MULTIPoint HANDLE SET INSTALLATION INSTRUCTIONS



EXPLODED VIEW

INSTALLATION FASTENERS

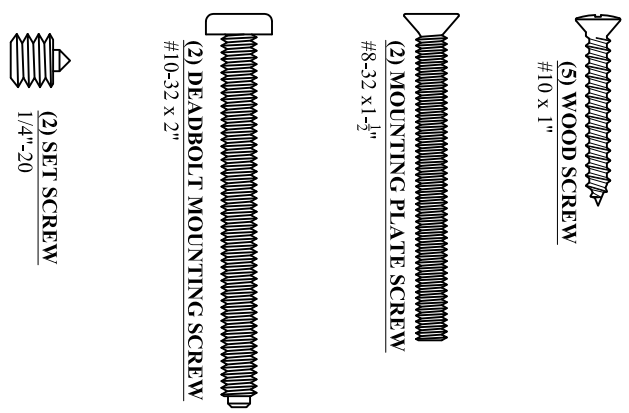

BEFORE YOU BEGIN

Check door thickness as handle will work with a 1-3/4" thick door only. If door thickness is greater than 1-3/4" up to 2-1/4" thick please contact Rockwell Security Inc.

Remove and discard all packaging materials and verify you have all the parts in the exploded view section of instructions

Follow step by step installation instructions to ensure proper operation of handle set.

Always wear protective eyewear.

REQUIRED TOOLS

- Protective Eyewear
- #2 Phillips Screwdriver
- Pencil
- 1/8" Drill Bit

1. Determine the handing of your door. Standing on the outside of the door, if the hinges are to the left of the door then the door is left handed and if the hinges are to the right of the door then the door is right handed. Handle sets are supplied with left and right hand spindle transmissions to work on both left and right hand doors

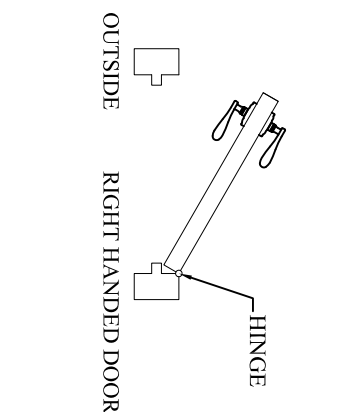
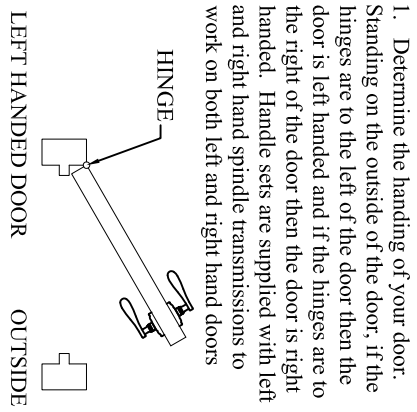

2. The handlesets are preset to work with a Left hand door, should you have a right hand door, the left handed spindle cartridge will need to be switched to a right hand spindle cartridge. **The handle set will not work properly if the incorrect cartridge is installed.**

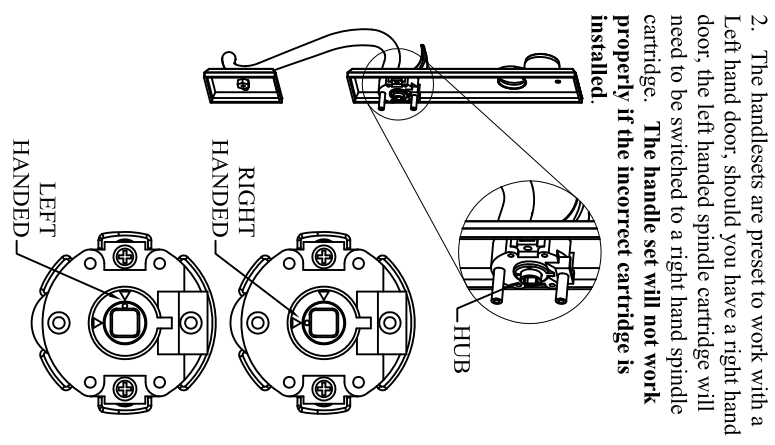

3. For A right hand door, please replace the spindle cartridge, with the correct right hand spindle cartridge. Right hand spindle cartridge (included) has instructions on changing the cartridge from left hand to right hand. For left hand doors, proceed to step 4. For Right hand doors, please replace spindle cartridge prior to proceeding to step 4. Ensure correct spindle cartridge hand is installed prior to proceeding to step 4.

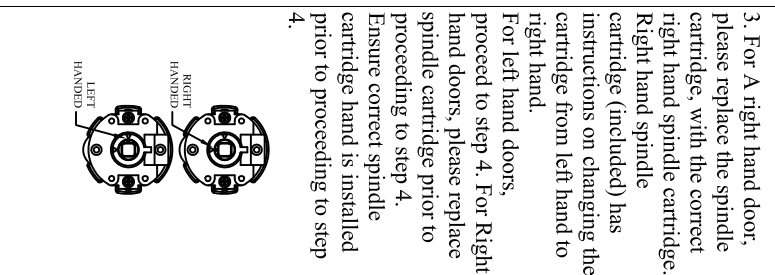

3. Slide the spindle collar onto the long end of the spindle.

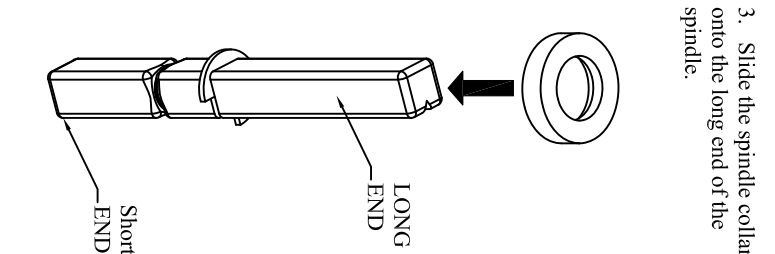

4. From the inside of the door insert the short end of the spindle into the latch of the lock ensuring the groove side of the long end of the spindle is facing down.

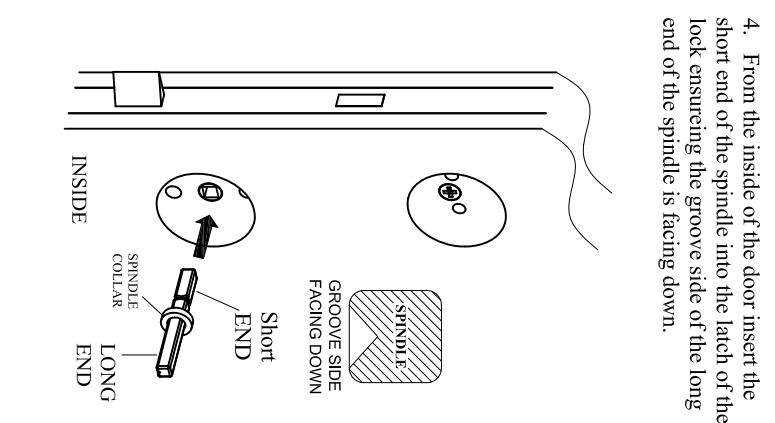

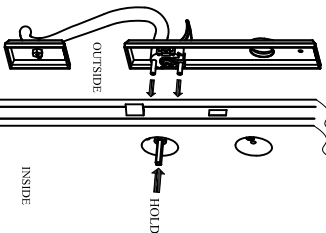
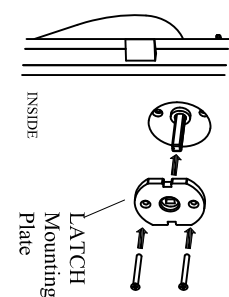
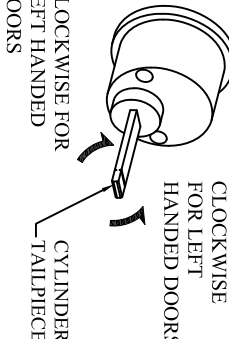
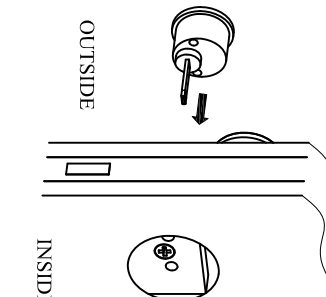
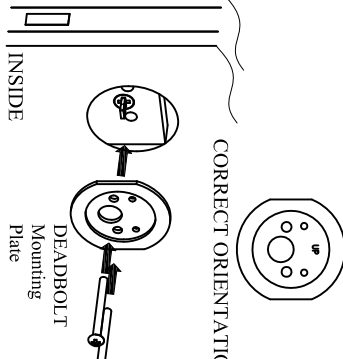
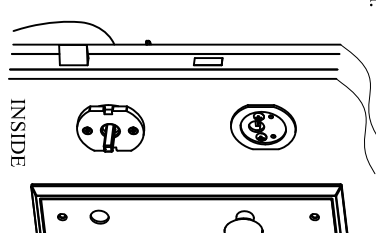
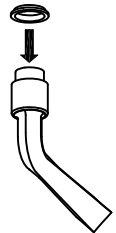
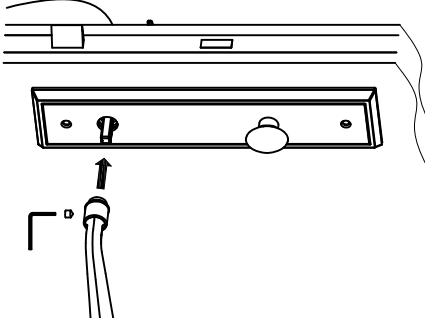
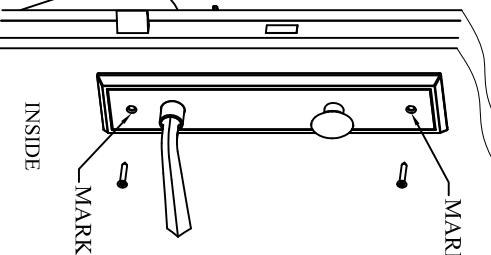
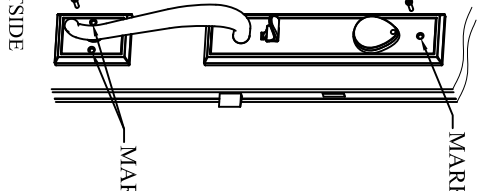
<p>5. Holding the spindle in place from the inside of the door, slide the spindle cartridge of the external pull assembly onto the spindle. Holding Spindle, test thumbpiece to retract latch.</p> 	<p>6. Hold the external handle set assembly in place and from the inside of the door slide the mounting plate onto the spindle. Secure the mounting plate using the two mounting plate screws. DO NOT OVER TIGHTEN MOUNTING SCREW.</p> 	<p>8. Based the door's handing from step 1, <i>without the key inserted</i> into the cylinder fully rotate the tailpiece clockwise for left handed doors and fully rotate the tailpiece counterclockwise for right handed doors. Note: IMPROPER ORIENTATION OF THE TAILPIECE WILL CAUSE THE DEADBOLT NOT TO FUNCTION PROPERLY</p> 	<p>9. From the outside of the door, keeping the tailpiece of the cylinder horizontal, insert the tailpiece through the external handle set assembly and into the "+" slot of the deadbolt. Ensure key is not inserted.</p> 	<p>10. From the inside of the door orient the turn piece mounting plate and secure by inserting the two deadbolt mounting screws through the turn piece mounting plate, lock and into the cylinder housing.</p> 
<p>11. Position the interior trim over the mounting plate and insert the cylinder tailpiece into the thumbturn of the interior trim.</p> 	<p>12. Place the plastic washer on the shank of the lever.</p> <p>Test Operation of the thumbturn, key and thumbpiece prior to proceeding further.</p> 	<p>13. Press the lever snugly against the interior trim assembly and tighten the set screw with the provided Allen wrench. Note: The set screw should not be located on the underside of the lever and should not be visible.</p> 	<p>14. Align the interior trim with the edge of the door and mark the position of the top and bottom screw hole locations. Drill a 1/8" pilot holes and secure the internal plate in place with two wood screws.</p> 	<p>15. Align the exterior trim with the edge of the door and mark the position of the top and bottom screw hole locations. Drill a 1/8" pilot holes and secure the external plate in place with three wood screws.</p> 

TROUBLE SHOOTING GUIDE

PROBLEM

Can't extend (lock) deadbolt unless key is in cylinder. Can't remove key from cylinder when the deadbolt is extended (locked).

When thumb grip is depressed or knob/lever is rotated the latch catches and doesn't spring back.

Knob or lever keeps coming off the spindle

Deadbolt can easily be lock using the interior plate assembly on the inside but is difficult to lock when locked with the key from the outside.

The thumb grip cannot be depressed to retract the latch.

SOLUTION

Cylinder tailpiece is not oriented properly. Remove the cylinder by first removing the turnpiece trim, and turnpiece mounting plate. Rotate the cylinder tailpiece 180 degrees and re-install the deadbolt assembly. Refer to steps 8 thru 10

Ensure door is at least 1'-3/4" thick. The mounting plate is installed too tight. Referring to step 6 back the two 1-1/2" flathead machine screw out until the latch operates freely

Ensure the spindle is oriented with the groove facing down and the set screw is securely tightened. Refer to steps 4 and 13.

The cylinder is not properly aligned with the interior plate assembly or improper door thickness. Remove the internal plate assembly and loosen the two mounting plate screws. Align the cylinder and retighten the deadbolt mounting screws. Ensure your door thickness is at least 1'-3/4" thick

Ensure door is at least 1'-3/4" thick. The orientation of the hub in the spindle cartridge is incorrect. Remove the handle and re-install refer to step 2 thru 6. Ensure the hub on the spindle cartridge is oriented properly.

Cannot extend deadbolt with the interior plate assembly or key when door is closed.

Open door and try to extend deadbolt. If deadbolt extends easily with the door open then the strike are not aligned with the deadbolt and/or locking points. Adjust the strike to align with the deadbolt and/or locking points.