

Rockwell Back To Back Tempered Glass Shower Door Handle

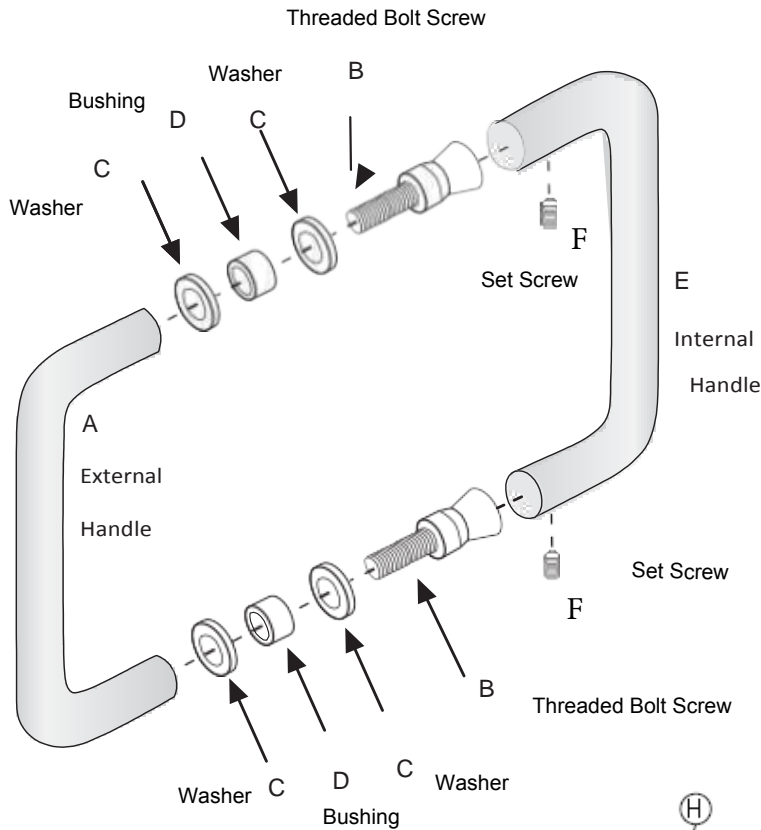

| | |
|---|---------------------|
| A | External Handle |
| B | Threaded Bolt Screw |
| C | Clear Washer |
| D | Bushing |
| E | Internal Handle |
| F | Set Screw |
| G | Large Allen Key |
| H | Small Allen Key |

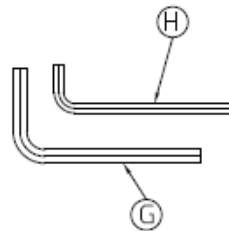

Note:

Bushings are packed with Allen Wrenches if not assembled on the Handle.

1. Disassemble the Shower Door handle using the small Allen Key (H) to loosen the 2 set screws (F) on the Internal Handle turning counterclockwise 3 -4 turns. You do not need to remove the set screws. After turning both the top and bottom set screws 3 to 4 turns, pull the 2 handles apart and they should disassemble.

2. Remove and disassemble the Large threaded bolt screw (B) from the external Handle, turning it counterclockwise or use the Larger Allen key (G) to remove the top and bottom screws from the External handle.

3. Once removed, Ensure to insert the 2 bushings (D) into the 2 holes of the glass door. Then take the 4 clear washers (C) and the 2 threaded bolt screws (B). From inside the door slide one clear washer (C) onto the Screw, then insert the screw through the glass hole and bushing (D) and through other clear washer (C) on other side of the Glass - external side of the glass.

4. Take the External Handle and align holes on the handles with the threaded bolt screws. Fasten both top and bottom bolt screws loosely with the external handle. Using the Large allen Key (G), tighten both top and bottom threaded bolt screws to fasten the external handle.

Please do not overtighten the screws.

5. Take the Internal handle (E) and align the holes with the threaded Bolt screws. Ensure to hold the handle flush against the door and there are no gaps between the handle, washer and the Glass door.

6. Using the smaller Allen Wrench Tighten the set screws while holding handle flush against the door.