

Dummy Function Installation Instructions for Sapphire Trim

DUMMY FUNCTION INSTALLATION INSTRUCTIONS

3. Match the lever orient the lever to the correct orientation and slide the lever onto the spindle of the dummy mounting bracket until the handle is flush with the trim plate. Insert and tighten the set screw with the Allen wrench provided to secure the handle.

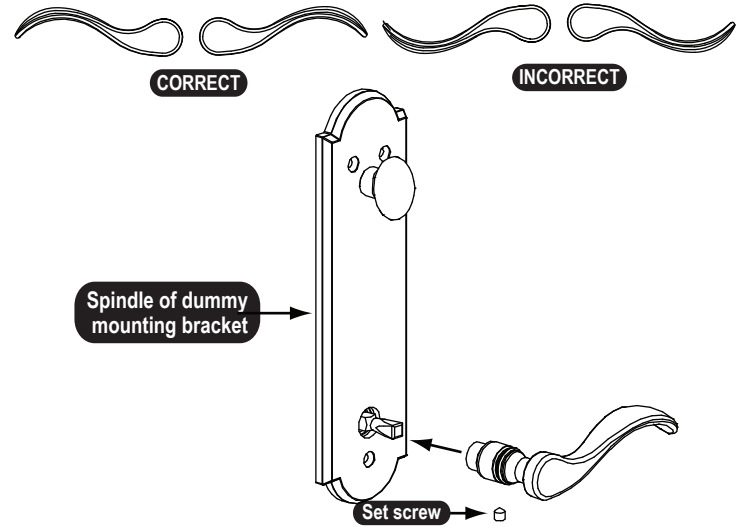

- Repeat steps 2 and 3 for the exterior trim plate and lever.
- Insert the dummy cylinder housing through the trim ring and exterior trim. Secure in place by installing the two 2" pan head machine screws through the deadbolt mounting plate and into the dummy cylinder housing.

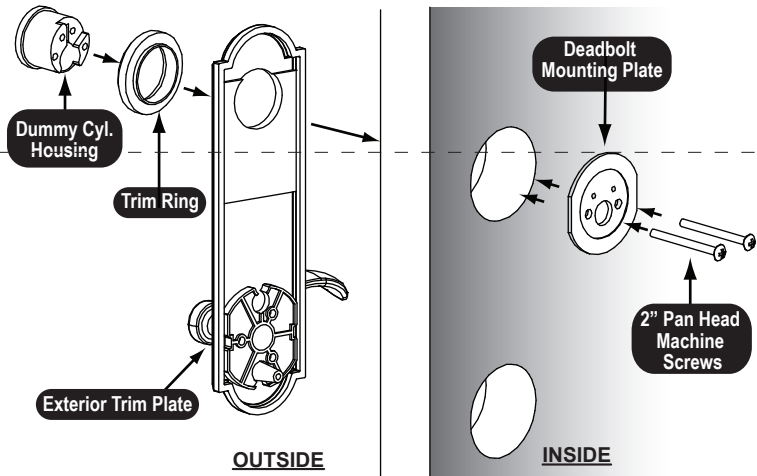

- Align the top 2 screw holes of interior trim with the deadbolt mounting plate. Secure the interior trim in place by installing the two 1" oval head machine screws through the top two screw holes. Install the 2-1/4" oval head machine screw through the bottom screw hole on the interior trim.

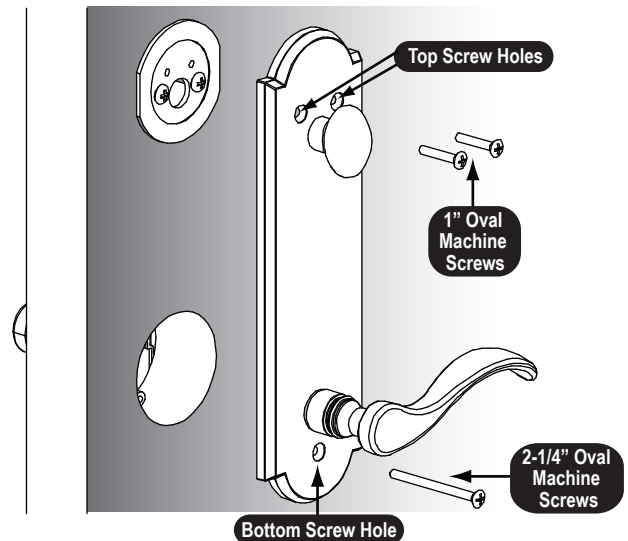

Tools Required

- Phillips screw driver

Always wear eye protection

Dummy Parts Kit

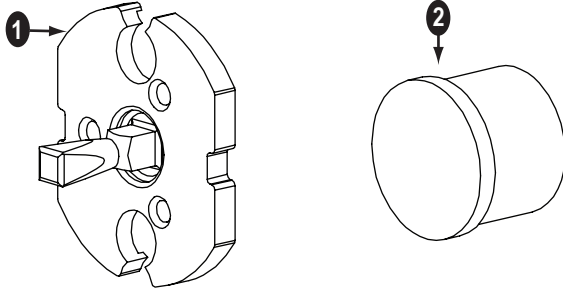

Dummy Parts Kit

- Dummy Mounting Bracket (2 pcs)
- Dummy Cylinder Housing

DUMMY FUNCTION INSTALLATION INSTRUCTIONS

1. Place the plastic washers on the shanks of both levers.

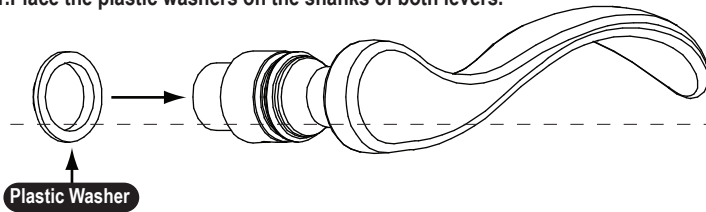

2. From the backside of the interior trim plate insert the spindle on the dummy mounting bracket through the bottom hole of the trim plate.

